



Hunt Estates

Three Bedroom Cottage with Uninterrupted St Ouen's Bay Sea Views
St Ouen , Jersey

THREE BEDROOM COTTAGE WITH UNINTERRUPTED ST OUEN'S BAY SEA VIEWS

This stunning property is set amongst just 14 cottages in one of the most picturesque locations in Jersey, enjoying uninterrupted views across St Ouen's Bay.

The home has been completely refurbished throughout to an exceptional standard, offering modern comfort in a beautiful coastal setting.

On the entrance level, you will find a utility room, cloakroom, and the primary bedroom with en-suite and large balcony allowing you to enjoy the panoramic views.

The lower ground floor a stunning open-plan kitchen, dining, and living area. This bright and spacious living space features underfloor heating and enjoys spectacular sea views.

The upper floor provides two further generously sized double bedrooms, served by the stylish house bathroom.

Externally, the property benefits from two allocated parking spaces, bin storage, a communal bike shed, and an electric vehicle charging point.





Hunt Estates

CHRISTIE'S
INTERNATIONAL REAL ESTATE



Hunt Estates

CHRISTIE'S
INTERNATIONAL REAL ESTATE





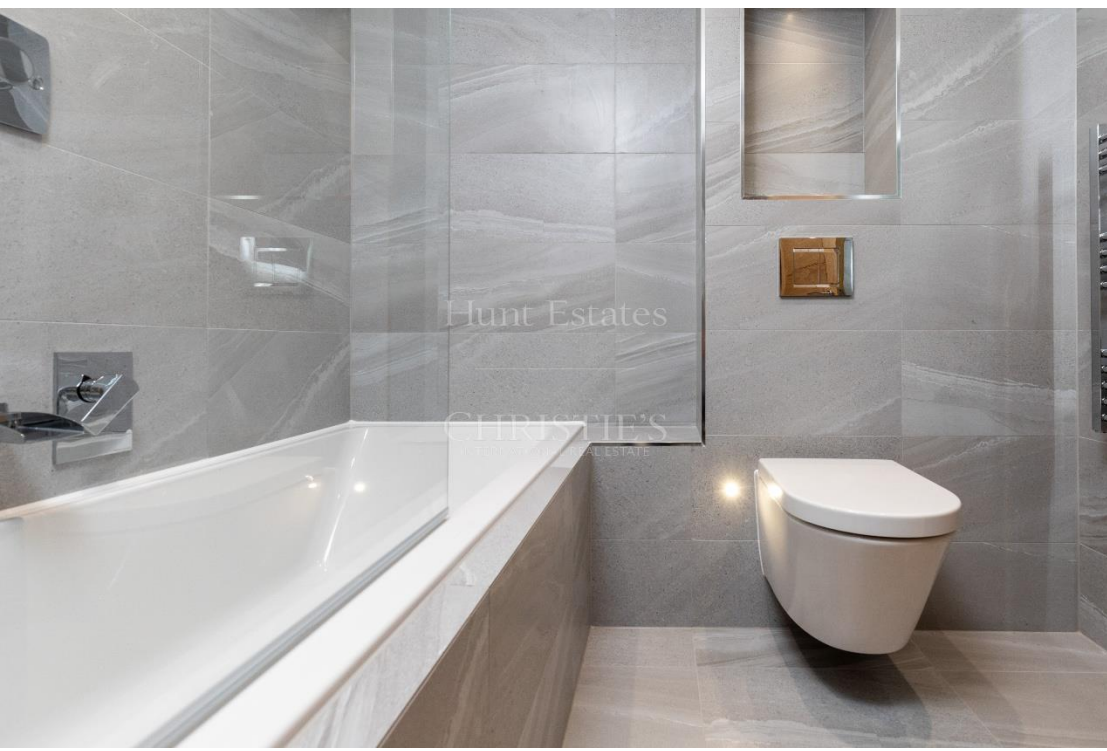

Hunt Estates

CHRISTIE'S
INTERNATIONAL REAL ESTATE





Hunt Estates

CHRISTIE'S
INTERNATIONAL REAL ESTATE

FEATURES

- Cottage style home
- Three bedrooms and two bathrooms
- Newly refurbished
- Short stroll to the beach
- Balcony with uninterrupted sea views
- Communal bike and bin storage

INFORMATION

- Mains drains and water
- Underfloor heating
- Double glazed
- 2 tandem parking spaces
- Electric Charging Point
- Parish rates for 2025 were £186.96
- Freehold and Entitled/Licensed



Sarah Gallichan
Property Negotiator

sarah@huntstates.com
T +44 (0)7700 713574
www.huntstates.com
9 New Street, St Helier,
Jersey, JE2 3RA

CHRISTIE'S | Hunt Estates
INTERNATIONAL REAL ESTATE

GROSS INTERNAL AREA
 GROUND FLOOR: 440 sq. ft, 40.8 m2, FIRST FLOOR: 399 sq. ft, 37.0 m2, SECOND FLOOR: 370 sq. ft, 34.4 m2
 TOTAL: 1209 sq. ft, 112.3 m2

EXCLUDED AREAS: REDUCED HEADROOM BELOW 1.5M: 33 sq. ft, 3.1 m2

SIZES AND DIMENSIONS ARE APPROXIMATE, ACTUAL MAY VARY

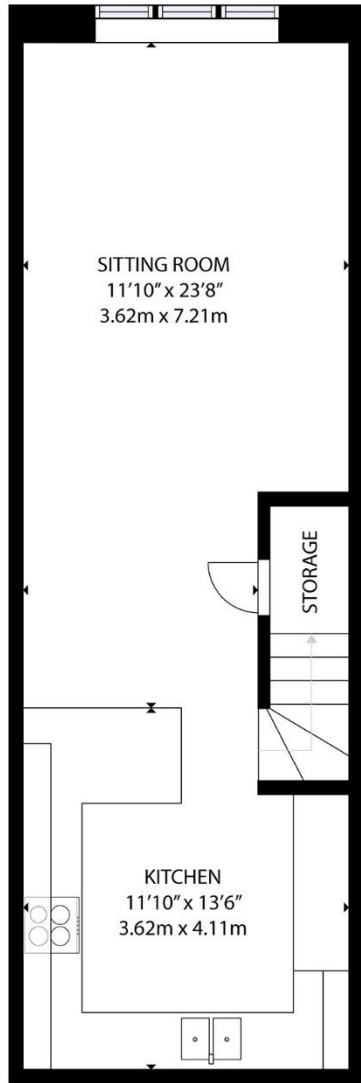

GROUND FLOOR

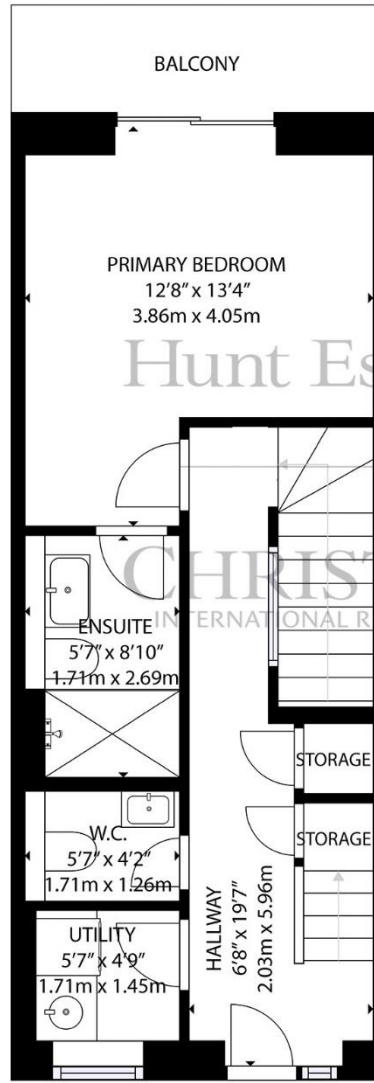

FIRST FLOOR

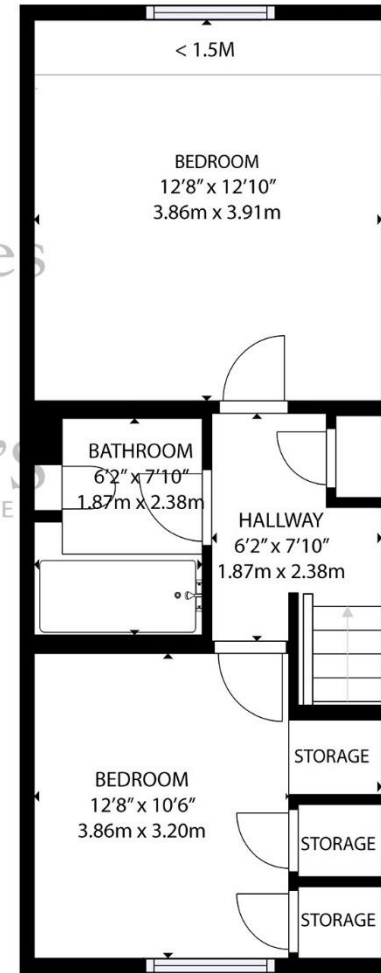

SECOND FLOOR

Hunt Estates

9 New Street, St Helier, Jersey, JE2 3RA, Channel Islands | +44 1534 860650 | www.huntestates.com | enquiries@huntestates.com

Disclaimer: All information provided herein has been obtained from sources believed reliable, but may be subject to errors, omissions, change of price, prior sale, withdrawal without notice. Hunt Estates make no representation, warranty, or guarantee as to the accuracy of any information contained herein; interested parties should conduct their own investigations and seek independent advice. No tests have been carried out on any fixtures, fittings, services, or appliances. Measurements are approximate, and photographs are for guidance only. All viewings must be arranged through Hunt Estates.