



Hunt Estates

CHRISTIE'S
INTERNATIONAL REAL ESTATE

Hunt Estates

CHRISTIE'S
INTERNATIONAL REAL ESTATE

Detached Gated Family Home
St Martin, Jersey

DETACHED GATED FAMILY HOME – ST MARTIN (MAUFANT)

Situated in the sought-after Maufant area of St Martin, this detached three-bedroom home offers privacy, generous outside space and excellent scope for future enhancement making it an ideal purchase for first-time buyers or growing families.

The ground floor comprises an entrance hall with useful storage, a comfortable lounge featuring a wood-burning stove and direct access to the garden, and a fully fitted eat-in kitchen, also with access to the outside. A cloakroom completes the ground floor accommodation.

On the first floor, there are three well-proportioned double bedrooms and a house bathroom. There is also clear potential to convert the loft into a fourth bedroom with en-suite, subject to the necessary consents.

Externally, the property sits on one of the largest plots within the development and enjoys a high degree of privacy, being fully gated and bordered by mature planting. There is a single garage and parking for a further three vehicles.

This immaculately presented home offers a rare combination of space, privacy and potential in a desirable parish location.

Please contact us today to arrange a viewing.









Hunt Estates

CHRISTIE'S
INTERNATIONAL REAL ESTATE



Hunt Estate

CHRISTIE'S
INTERNATIONAL REAL ESTATE





Hunt Estate

CHRISTIE'S
INTERNATIONAL REAL ESTATE



Hunt Estate

CHRISTOPHER
INTERNATIONAL







Hunt Estates

CHRISTIE'S
INTERNATIONAL REAL ESTATE

FEATURES

- Detached gated home on one of the largest plots in the development
- Three double bedrooms with potential to create a fourth in the loft
- Lounge with wood-burning stove and garden access
- Fully fitted eat-in kitchen with direct access to the garden
- High level of privacy with mature planting and enclosed grounds
- Excellent scope to extend or further enhance (subject to planning)

INFORMATION

- Mains drains and water
- Electric heating
- Double glazed
- Single garage
- Parking for 3 cars
- Parish rates for 2025 were £482.60
- Freehold and Entitled/Licensed

LOCATION

What3words: [//parachutes.bongos.ogling](https://www.what3words.com/?q=//parachutes.bongos.ogling)



Chris Duhamel
Property Negotiator

chris@huntstates.com
T +44 (0)7700 703525
www.huntstates.com
9 New Street, St Helier,
Jersey, JE2 3RA

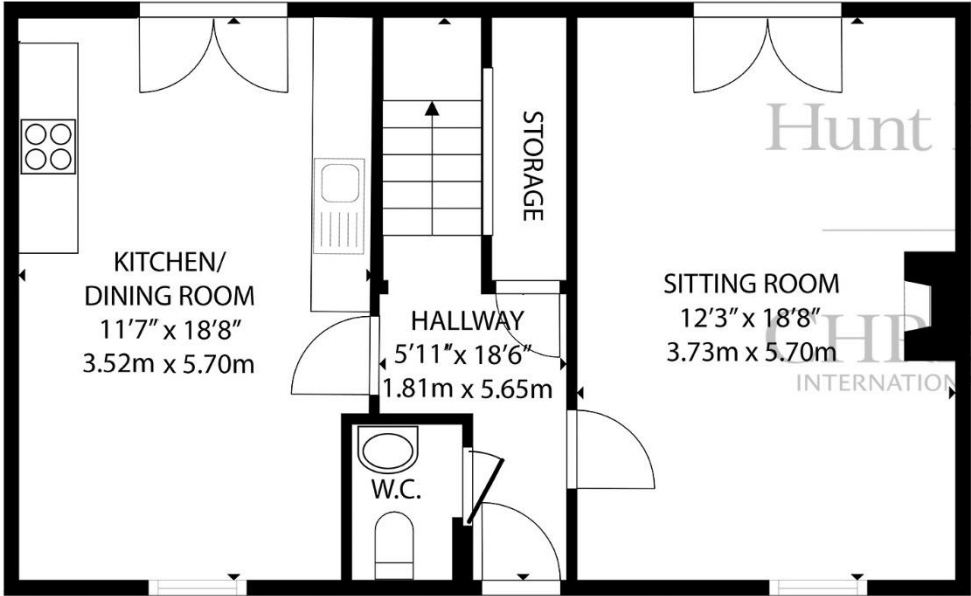
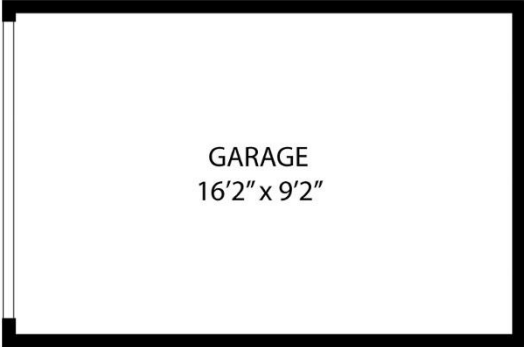

GROUND FLOOR

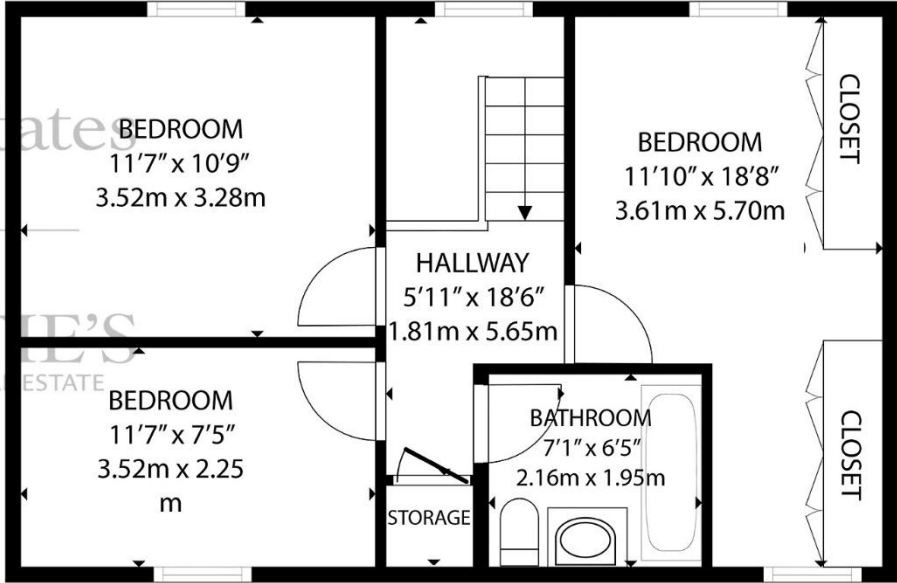

FIRST FLOOR

GROSS INTERNAL AREA
GROUND FLOOR: 554 sq. ft, 51.4 m², FIRST FLOOR: 541 sq. ft, 50.2 m²
TOTAL: 1095 sq. ft, 101.7 m²

EXCLUDED AREAS: GARAGE: 148 sq. ft, 13.7 m²

SIZES AND DIMENSIONS ARE APPROXIMATE, ACTUAL MAY VARY

As the selected exclusive affiliate of Christie's International Real Estate in Jersey, Channel Islands, Hunt Estates combines local expertise with global reach via Christie's affiliation to the most famous real estate companies in the world. An invitation-only affiliate network, Christie's International Real Estate selected Hunt Estates in 2020 to represent the famous Christie's brand in the sphere of luxury real estate in Jersey.

Hunt Estates

CHRISTIE'S

INTERNATIONAL REAL ESTATE

9 New Street, St Helier, Jersey, JE2 3RA, Channel Islands | +44 1534 860650 | www.huntestates.com | enquiries@huntestates.com

Disclaimer: All information provided herein has been obtained from sources believed reliable, but may be subject to errors, omissions, change of price, prior sale, withdrawal without notice. Hunt Estates make no representation, warranty, or guarantee as to the accuracy of any information contained herein; interested parties should conduct their own investigations and seek independent advice. No tests have been carried out on any fixtures, fittings, services, or appliances. Measurements are approximate, and photographs are for guidance only. All viewings must be arranged through Hunt Estates.