



Hunt Estates

CHRISTIE'S  
INTERNATIONAL REAL ESTATE

Sixth Floor One-Bedroom Apartment  
St Helier, Jersey

## SIXTH FLOOR ONE-BEDROOM APARTMENT, HORIZON DEVELOPMENT

Situated within the prestigious Horizon development, completed in late 2023, this impressive sixth floor apartment in Horizon West offers contemporary coastal living with stunning views across St Aubin's Bay.

Residents benefit from a concierge service, welcoming reception area, secure post facilities, and lift access to all floors, providing both convenience and security.

Internally, the apartment features a spacious open-plan lounge, kitchen and dining area, enhanced by floor-to-ceiling glazing that floods the space with natural light and frames the sea views. The living area provides access to a west-facing balcony, perfect for enjoying afternoon and evening sun.

The double bedroom is fitted with bespoke floor-to-ceiling wardrobes and benefits from access to a second west-facing balcony. A modern bathroom completes the accommodation.

Extending to approximately 657sq ft., the apartment offers generous living space for a one-bedroom home.

Ideally located within walking distance of the finance district, beaches, cafés, restaurants and local amenities, this property presents an excellent opportunity for professionals or investors seeking a high-quality, low-maintenance home in the heart of St Helier.

Hunt Estates





Hunt Estates

CHRISTIE'S  
INTERNATIONAL REAL ESTATE



Hunt Estates

CHRISTIE'S  
INTERNATIONAL REAL ESTATE







Hunt Estates

CHRISTOPHER  
INNOVATIVE REAL ESTATE







Hunt Estates



CHRISTIE'S  
INTERNATIONAL REAL ESTATE

Hunt Estates

CHRISTIE'S  
INTERNATIONAL REAL ESTATE





## FEATURES

- X Sixth floor apartment within the prestigious Horizon development (2023)
- Open-plan living with floor-to-ceiling windows and sea view
- Two west-facing balconies with afternoon and evening sun
- Double bedroom with bespoke fitted wardrobes
- Concierge service, lift access and secure entry system
- Approx. 657 sq. ft of modern, well-designed living space

## INFORMATION

- Mains drains and water
- Electric heating
- Double glazed
- Service charges are £260 pm ( Parish rates included )
- Share Transfer

## LOCATION

What3words: ///composer.deciding.hovered



Chris Duhamel  
Property Negotiator

chris@huntstates.com  
T +44 (0)7700 703525  
www.huntstates.com  
9 New Street, St Helier,  
Jersey, JE2 3RA

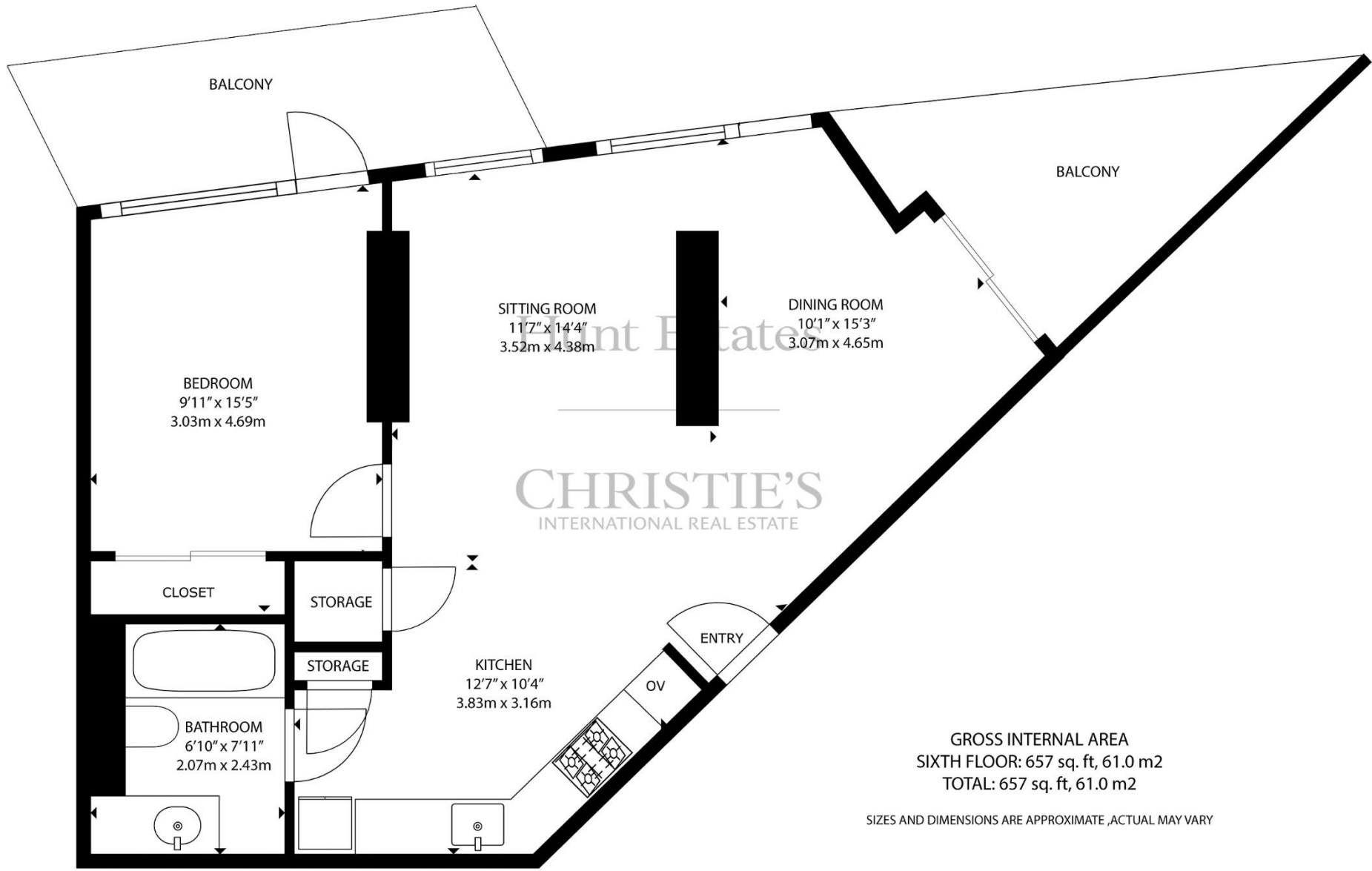

SIXTH FLOOR

GROSS INTERNAL AREA  
SIXTH FLOOR: 657 sq. ft, 61.0 m2  
TOTAL: 657 sq. ft, 61.0 m2

SIZES AND DIMENSIONS ARE APPROXIMATE ,ACTUAL MAY VARY

As the selected exclusive affiliate of Christie's International Real Estate in Jersey, Channel Islands, Hunt Estates combines local expertise with global reach via Christie's affiliation to the most famous real estate companies in the world. An invitation-only affiliate network, Christie's International Real Estate selected Hunt Estates in 2020 to represent the famous Christie's brand in the sphere of luxury real estate in Jersey.

# Hunt Estates

# CHRISTIE'S

INTERNATIONAL REAL ESTATE

9 New Street, St Helier, Jersey, JE2 3RA, Channel Islands | +44 1534 860650 | [www.huntestates.com](http://www.huntestates.com) | [enquiries@huntestates.com](mailto:enquiries@huntestates.com)

Disclaimer: All information provided herein has been obtained from sources believed reliable, but may be subject to errors, omissions, change of price, prior sale, withdrawal without notice. Hunt Estates make no representation, warranty, or guarantee as to the accuracy of any information contained herein; interested parties should conduct their own investigations and seek independent advice. No tests have been carried out on any fixtures, fittings, services, or appliances. Measurements are approximate, and photographs are for guidance only. All viewings must be arranged through Hunt Estates.