



Hunt Estates

CHRISTIE'S  
INTERNATIONAL REAL ESTATE

Modern Two-Bedroom Ground Floor Apartment  
St Helier, Jersey

## FEATURES

- 2 bedrooms, 1 bathroom
- Modern ground floor apartment within a 2021 redevelopment
- Open-plan lounge, kitchen and dining space
- Approx. 767 sq. ft. of internal living space
- Useful internal storage throughout
- Prime La Motte Street location moments from town amenities

## INFORMATION

- Mains drains, mains water
- Electric heating
- Double glazed
- No parking
- Service charges £220.00 pcm
- Parish rates for 2025 were £350.00
- Flying Freehold and Entitled/Licensed

## LOCATION

What3words: ///market.song.luggage

## MODERN TWO-BEDROOM GROUND FLOOR APARTMENT

Forming part of a redevelopment completed in 2021, this modern ground floor apartment offers contemporary, low-maintenance living in a highly convenient central St Helier location.

The accommodation briefly comprises a bright open-plan lounge, kitchen and dining area, two well-proportioned bedrooms, a house bathroom, and useful internal storage cupboards.

Offering approximately 767 sq. ft. of living space, the apartment provides generous accommodation, making it an excellent option for first-time buyers, professional couples, or investors seeking a strong rental opportunity.

Situated on La Motte Street, the property is just a stone's throw from St Helier town centre, placing shops, restaurants, cafés and everyday amenities right on your doorstep.

A superb opportunity to secure a modern home in a prime town location.

Please contact us today to arrange a viewing.





Hunt Estates

CHRISTIE'S  
INTERNATIONAL REAL ESTATE







Hunt Estates

CHRISTIE'S  
INTERNATIONAL REAL ESTATE





Hunt Estates

CHRISTIE'S  
INTERNATIONAL REAL ESTATE



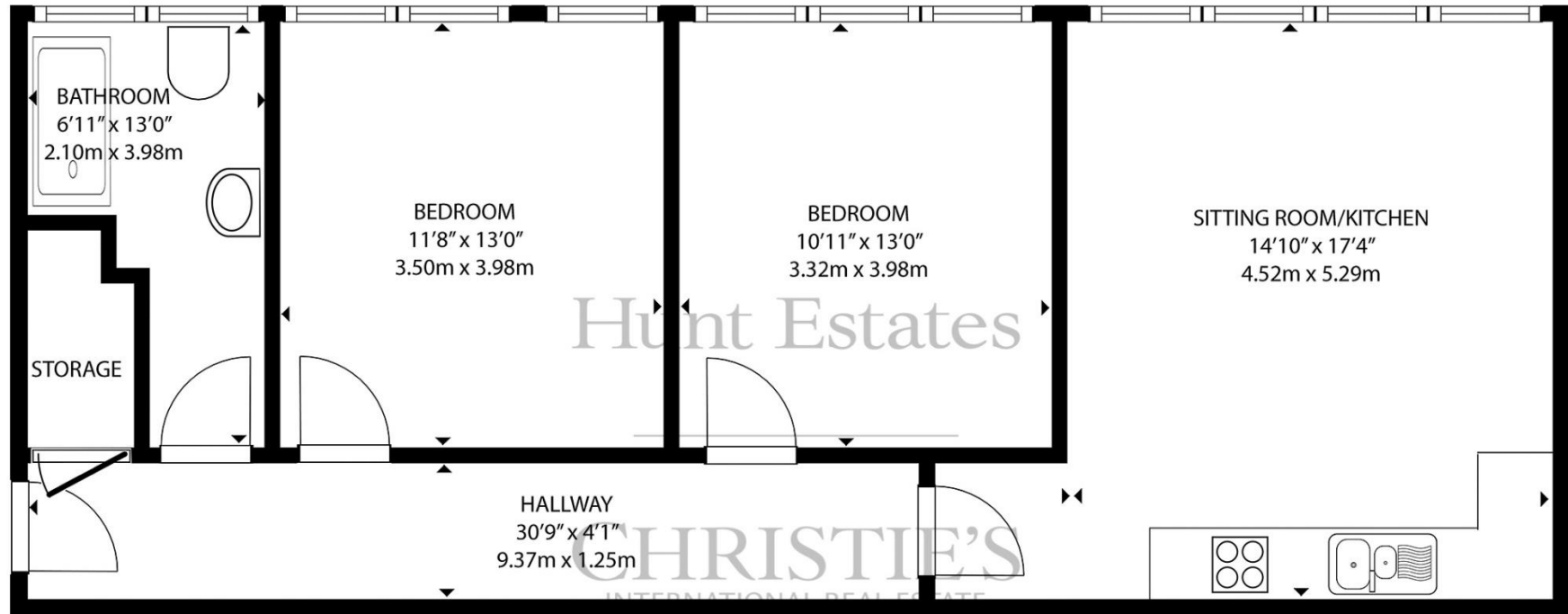

GROUND FLOOR

GROSS INTERNAL AREA  
GROUND FLOOR: 767 sq. ft, 71.4 m<sup>2</sup>  
TOTAL: 767 sq. ft, 71.2 m<sup>2</sup>

SIZES AND DIMENSIONS ARE APPROXIMATE, ACTUAL MAY VARY

As the selected exclusive affiliate of Christie's International Real Estate in Jersey, Channel Islands, Hunt Estates combines local expertise with global reach via Christie's affiliation to the most famous real estate companies in the world. An invitation-only affiliate network, Christie's International Real Estate selected Hunt Estates in 2020 to represent the famous Christie's brand in the sphere of luxury real estate in Jersey.

# Hunt Estates

# CHRISTIE'S

INTERNATIONAL REAL ESTATE

9 New Street, St Helier, Jersey, JE2 3RA, Channel Islands | +44 1534 860650 | [www.huntestates.com](http://www.huntestates.com) | [enquiries@huntestates.com](mailto:enquiries@huntestates.com)

Disclaimer: All information provided herein has been obtained from sources believed reliable, but may be subject to errors, omissions, change of price, prior sale, withdrawal without notice. Hunt Estates make no representation, warranty, or guarantee as to the accuracy of any information contained herein; interested parties should conduct their own investigations and seek independent advice. No tests have been carried out on any fixtures, fittings, services, or appliances. Measurements are approximate, and photographs are for guidance only. All viewings must be arranged through Hunt Estates.